

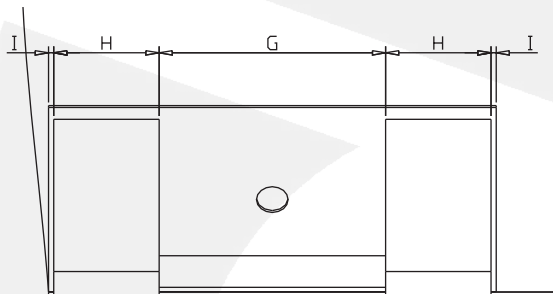

	A	B	C	D	E	F	G	H	I	J	K
CC15D01	1.200	1.705	1.510	715	900	475	265	60	20	115	172
CC17E01	1.200	1.705	1.510	715	1.000	575	265	60	20	115	172
CC26D03	1.200	1.705	1.510	715	1.000	575	265	60	20	115	172
CC26D02	1.200	1.705	1.510	715	1.000	575	265	60	20	115	172
CC30B01	1.500	1.910	1.700	880	1.300	875	215	100	5	115	167
CC42A01	1.600	2.100	1.890	950	1.520	1.110	215	1005	5	124	167
CC58A03	1.690	2.100	1.890	950	1.520	1.110	215	100	5	124	167
CC62C01	2.000	2.937	2.727	950	1.520	1.110	215	100	5	124	167
CC62A05	1.690	2.100	1.890	950	1.520	1.110	215	100	5	124	167
CC72A02	1.690	2.100	1.890	950	1.520	1.110	215	100	5	124	167
CC72A03	1.690	2.100	1.890	950	1.520	1.110	215	100	5	124	167
CC76A04	1.690	2.100	1.890	950	1.520	1.110	215	100	5	124	167

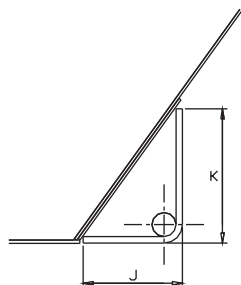
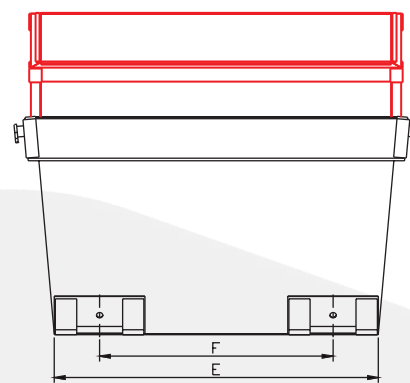
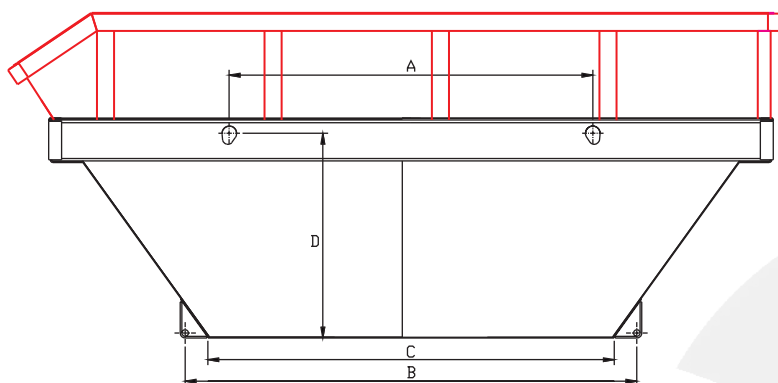

	CC15D01	CC17E01	CC26D03	CC26D02	CC30B01	CC42A01	CC58A03	CC62C01	CC62A05	CC72A02	CC72A03	CC76A04
Longitud (cm)	2,57	2,57	2,73	2,84	3,08	3,37	3,72	4,53	3,82	3,77	3,61	3,67
Anchura (cm)	1,23	1,33	1,23	1,23	1,68	1,90	1,90	1,90	1,90	1,90	1,90	1,90
Altura (cm)	0,81	0,81	1,21	1,21	0,95	1,02	1,27	1,02	1,37	1,52	1,52	1,62
Capacidad (m ³)	1,5	1,7	2,6	2,6	3,0	4,2	5,8	6,2	6,2	7,2	7,2	7,6
Peso (Kg.)	-----	-----	-----	-----	-----	-----	-----	-----	-----	-----	-----	-----
Resistencia (Tn.)	-----	-----	-----	-----	-----	-----	-----	-----	-----	-----	-----	-----
Grosor de chapa (mm)	3/4 · 4/5				3/4 · 4/5 · 5/6							
Tipo de material	St 37-2				Antidesgaste				Corten-A			
Manipulable con equipo	Multi-Container (CayVol) o similar											
Contenedor apilable	Si											
Nº de componentes	36	38	56	58	38	38	46	38	52	60	60	60
Tipo de imprimación	Imprimación Antioxidante											
Tipo de pintura	Esmalte Sintético											